

Introduction

1. Rear light unit
2. LED light
3. Retro reflector
4. Screw slot
5. Support pin
6. Mud guard
7. Dual cable
8. Screw
9. Holes for screw, support pin and cabling
10. Power input slide

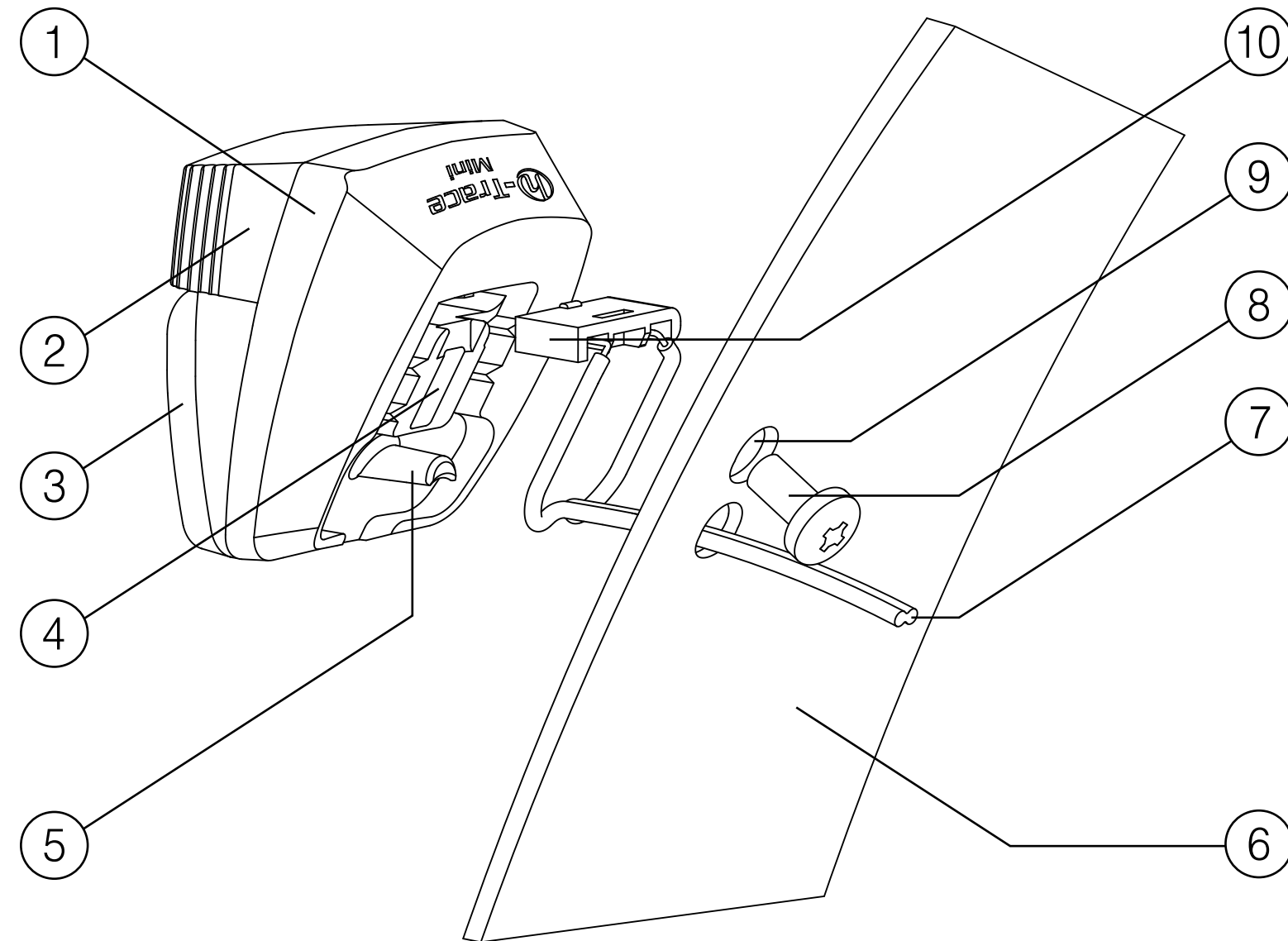

General:

This product is intended to be used assembled on a bicycle for trekking, commuting, and on-road applications. Product is not intended for off road use.

The Light works with 6V 3W and 6V 1,5W dynamos.

Product is in accordance with the German StVZO-, and French TP RBi requirements. The red retro reflector meets the European E1 A, and the German K regulations. Approval numbers can be found on the side surfaces of the rear light unit, and on main surface of the retro reflector.

The light does not feature an on-off switch, it is designed to be on whenever the cables are connected, and power is running through them.

Stand light function of the light works by storing part of the energy generated in a condenser when you are riding. It is fully loaded after approximately three minutes. When the bike stops, the LED runs with the power from the condenser, and lets other road users know of your presence whilst standing still.

Care and disposal:

The Light is generally designed to be maintenance free in its intended use scenario. The LED will last the lifetime of the lamp. The electronics are protected against overvoltage from the dynamo.

When cleaning is needed use a damp cloth, and mild general detergent. Do not submerge the light unit, as this is likely to cause damage.

Do not dispose the product within household waste. Dispose the product according to WEEE -regulations at a certified collection point.

This product is guaranteed against defects in materials, and craftsmanship for a period of two years.

For more information consult your retailer, or contact herrmans@herrmans.eu.

Herrmans Oy Ab
PB36
68601 Jakobstad, Finland

Power input slide

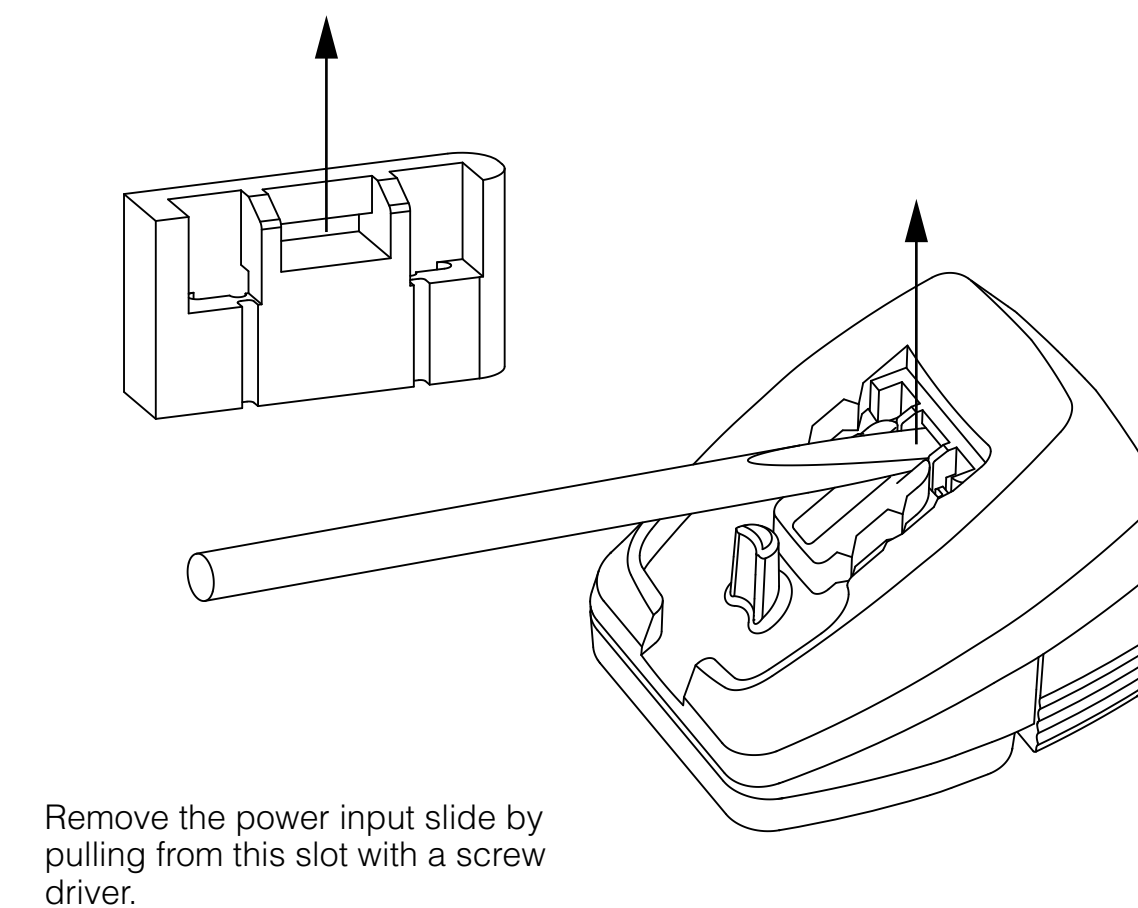

Power input slide assembly

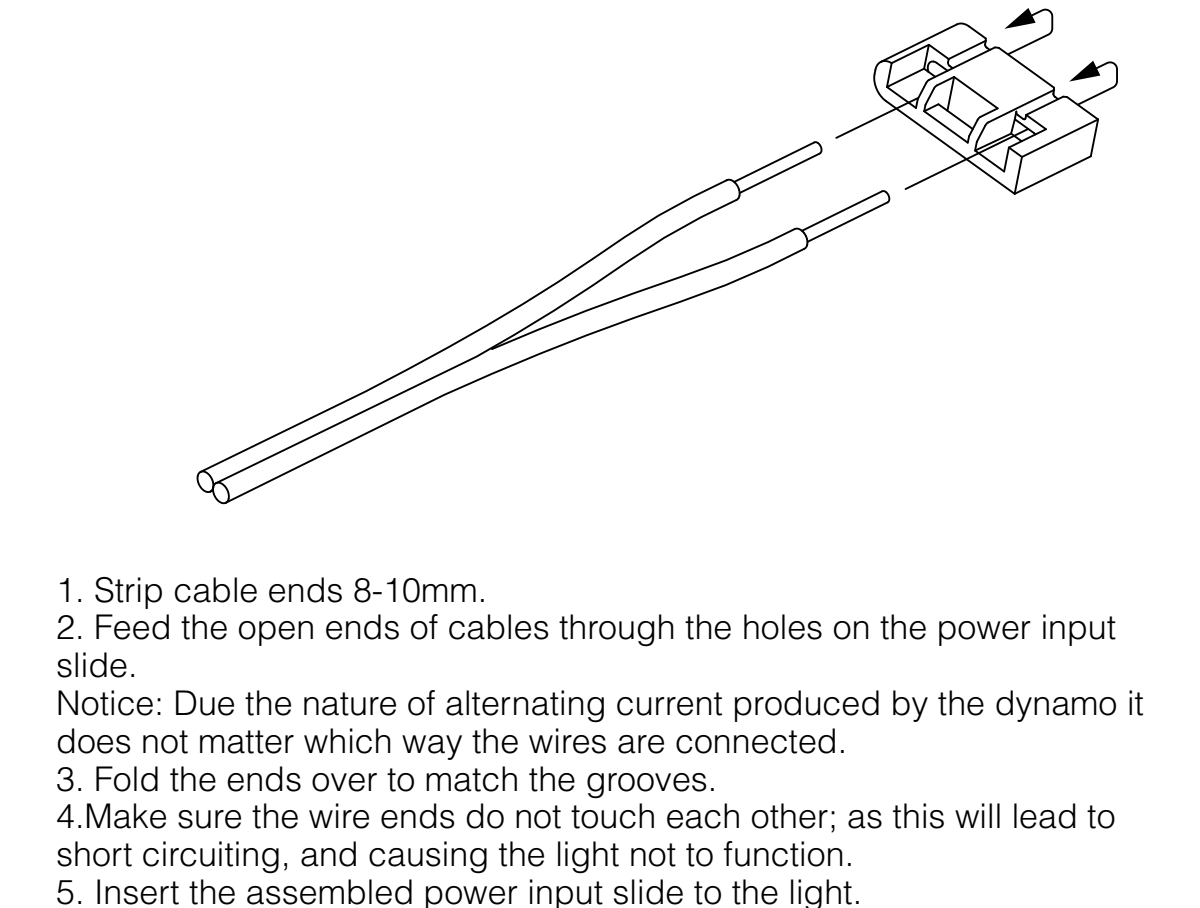

Power input slide orientation

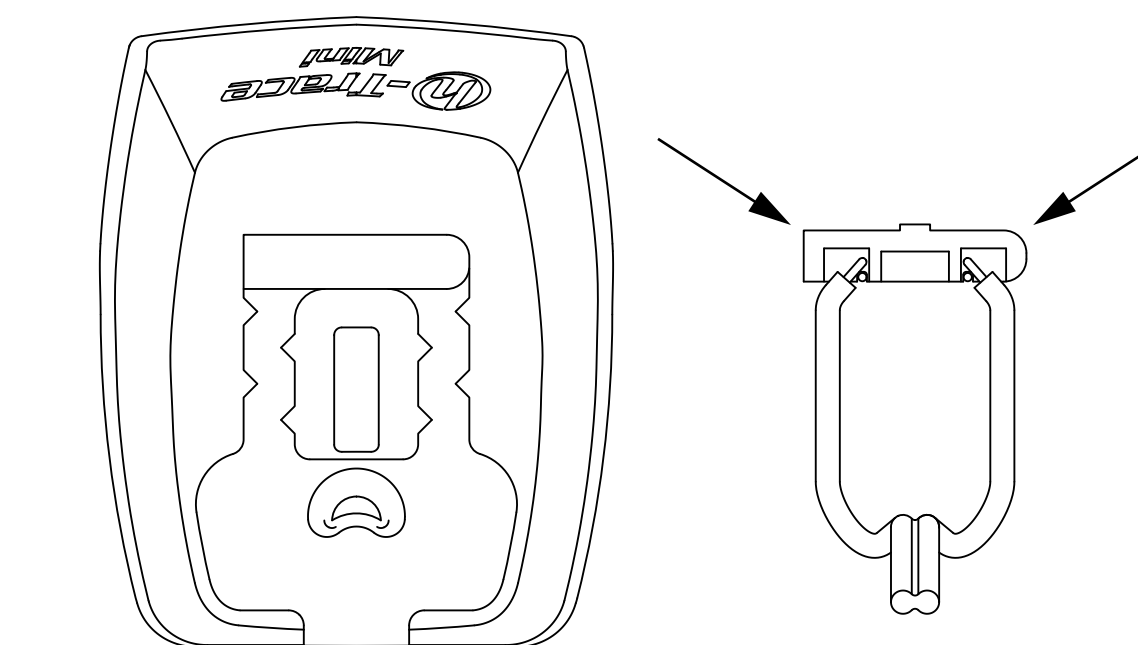

Notice the squared, and rounded sides. Orient the pieces accordingly.

Cable routing

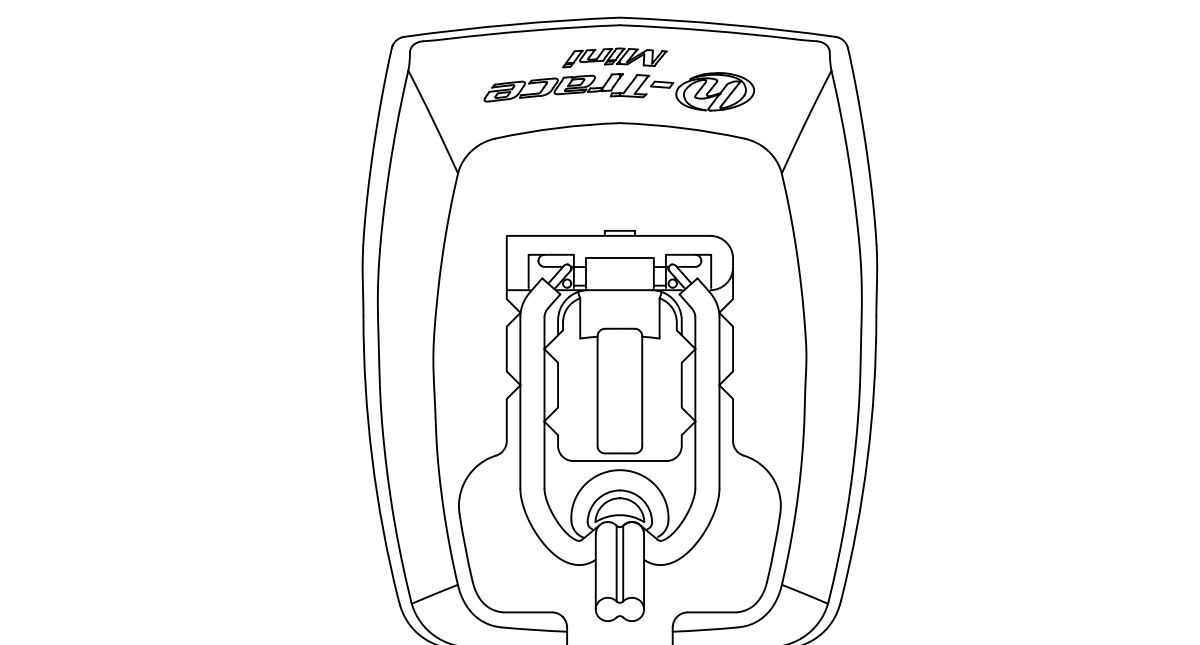

Alternative cable exits: 1. Support pin hole 2. Slot at the bottom

Mudguard hole drilling instructions

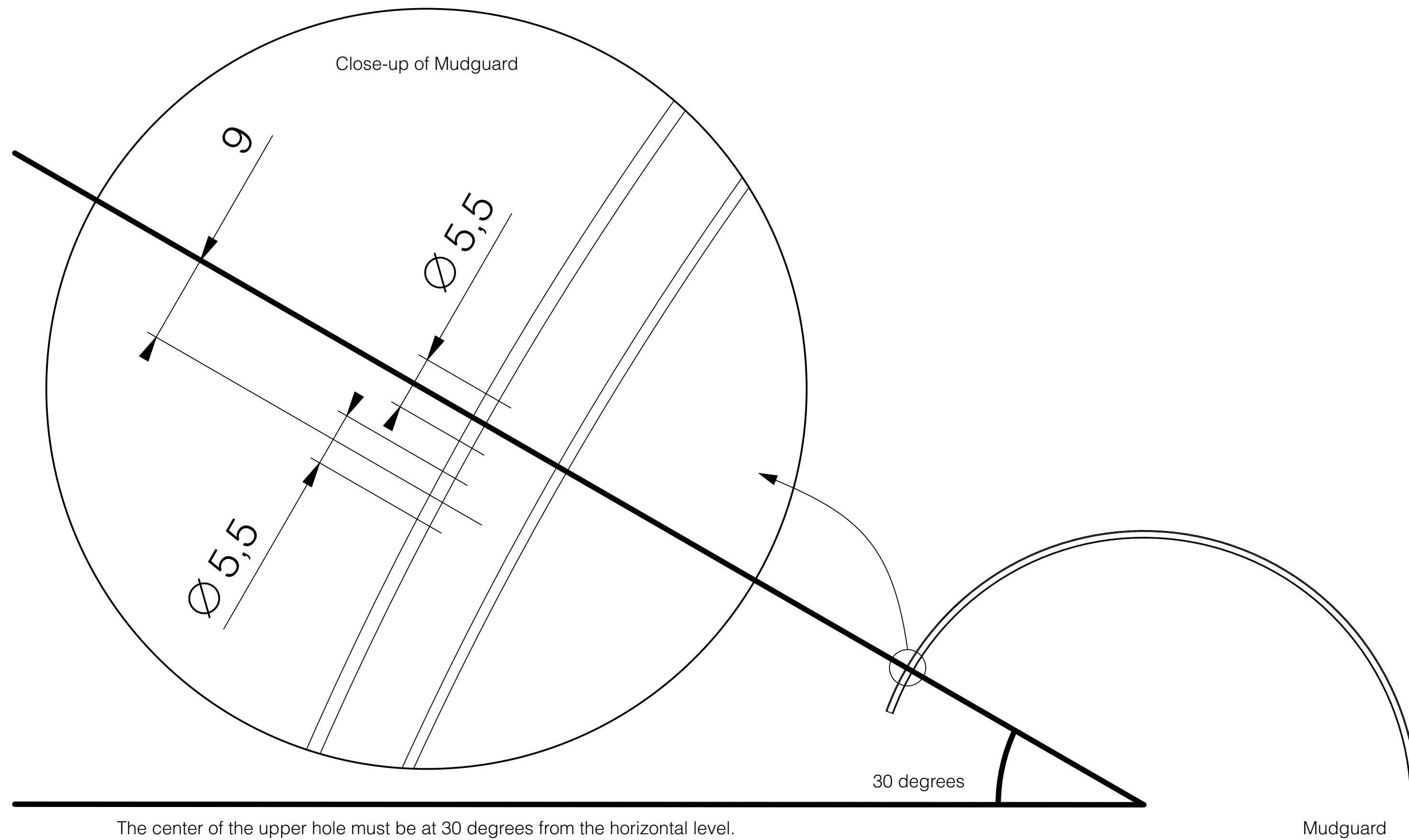

Orientation of light unit

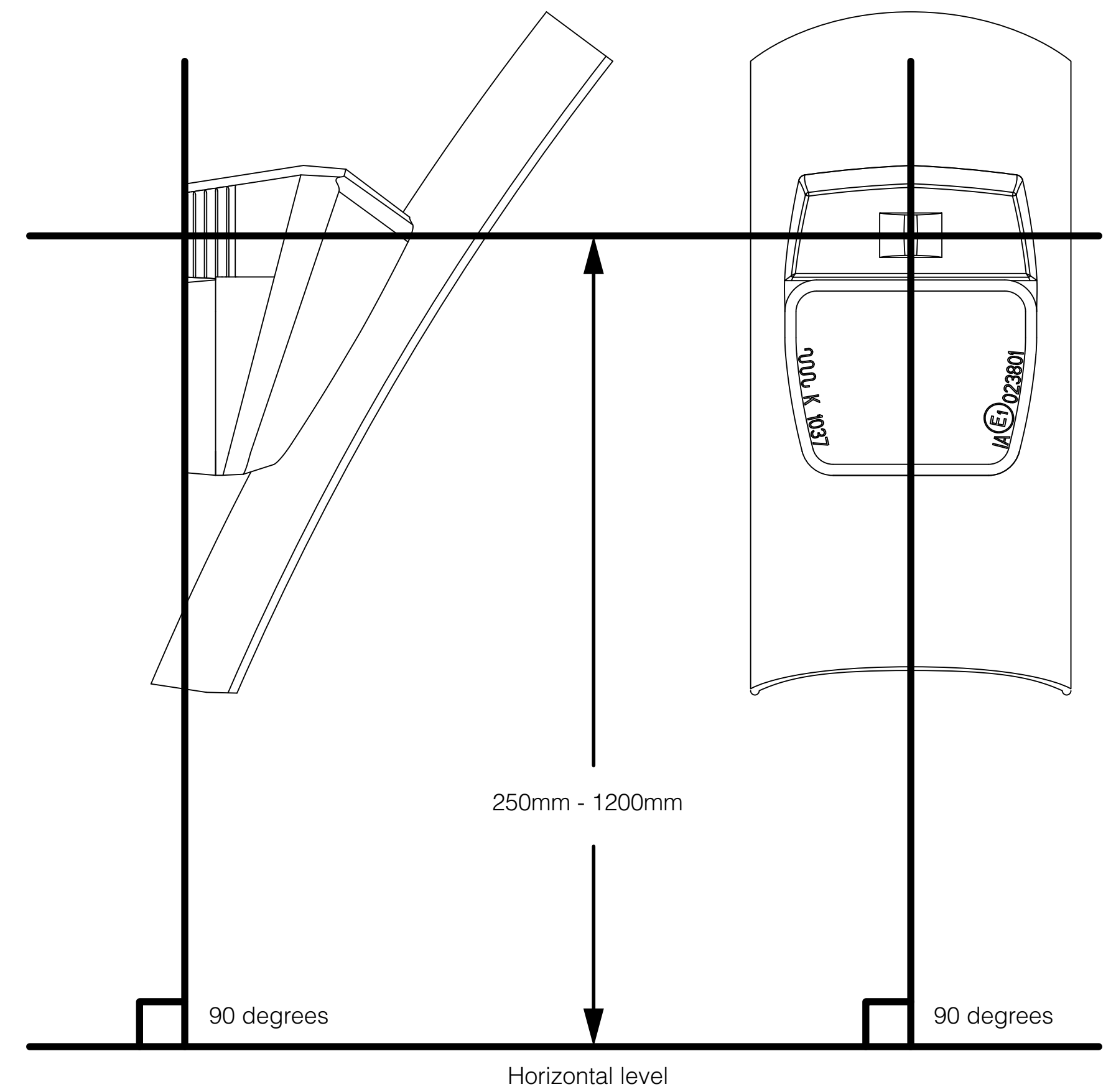

Seat stay bracket assembly

1. Disassemble the Seatstay bracket unit by removing two 20mm PT-screws (1) securing the metal arm (2) of the bracket
2. Attach the metal arm (2) to the light unit with a 9.5mm screw (3).
 - Tighten the screw until the metal arm (2) is fully pressed against the light frame
3. Assemble the Seatstay bracket halves on to the bicycle frame.
 - Place the base part (4) against the metal arm (2), then the clamp part (5) behind the Seatstay tube and assemble 20mm PT-screws (1)

Tip! When reassembling PT-screws (1) rotate them first counter clockwise; once feeling a small notch you can start turning clockwise. This way the screw is rethread to the already existing thread on the plastic.

- Adjust the light so that it faces directly backwards, see detailed instructions on the second page of "User manual H-trace mini dynamo".
- Tighten the screws (1)

4. Electrical connections

- See page first page of "User manual H-trace mini dynamo" for reference.
- Power cable can be routed between the metal arm and the housing body. This has to be done before attaching the light unit to the metal arm (step 2).

NOTE!

- Do not to over tighten the screws.
- Bracket is suitable for seatstay tube diameters from 14mm to 22mm.

